

Pompidou 2415

Luxury Vinyl • Galleria

Product Specifications

Market Segments	Builder, Hospitality, Pro, Residential, Senior Living, Workspace
Sub Category	LVT
Collection	Galleria
Style Name	Pompidou
Style Number	2415
Construction	Luxury Vinyl
Format	Tile
Abrasion Resistance	General Commercial Use
Material	Virgin PVC
Width	12" (304.8 mm)
Total Thickness	0.197" (5 mm)
Wear Layer Thickness	0.0220" (0.5500 mm)
Interlayer	Fiberglass
Backing	Loose Lay
Edges	4-Sided Micro Bevel
Locking System	None
Finish	Stone
Top Surface	UV-Cured Polyurethane
Gloss	Matte
Pattern Repeat	6
IIC	66
STC	67
Design	Terrazzo
Formaldehyde	E1
Length	24" (609.6 mm)
Certifications	FloorScore, E1 Certified, Phthalates-Free, BLC Certification, QuickShip, Virgin PVC
Installation Methods	Loose Lay, Compatible with embedded radiant heating, Glued 🔗 Luxury Vinyl Installation Guide (Loose Lay or Gluedown) 🔗 Wall Installation Guide - Luxury Vinyl

Pompidou 2415

Luxury Vinyl • Galleria

Tile Packaging information

Units Per Box	12
Boxes Per Pallet	48
Box Weight	45.36 pounds (20574.93 grams)
Square Meters Per Box	2.23
Square Meters Per Pallet	107.02
Square Feet Per Box	24
Square Feet Per Pallet	1152

Warranties

- [Luxury Vinyl Warranty Guide](#)
- [Luxury Vinyl Care & Maintenance Guide](#)

Residential use

Petproof *Lifetime*
No Questions Asked Replacement *30 days*
Wear *Lifetime*
Manufacturing Defects *Lifetime*
Stain *Lifetime*
Fade *Lifetime*
Waterproof *Lifetime*

Commercial use

Fade *15 Years*
Wear *15 Years*
Stain *15 Years*
Manufacturing Defects *15 Years*
Waterproof *Lifetime*
Petproof *Lifetime*

Moldings

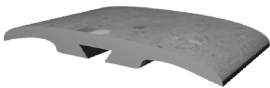

Multitrim
Coordinating
94" X 0.23" X 1.593"
(2388 mm X 5.842 mm X 40.481 mm)



Stair Nose
Coordinating
94" X 1.16" X 2"
(2388 mm X 25.4 mm X 50.80 mm)

Pompidou 2415

Luxury Vinyl • Galleria

Dimensional Tolerance

Test	Test method	Result
Height difference	Max 0.15 mm	Pass
Curling in the presence of heat	EN ISO 23999 (≤ 2 mm)	Pass
Squareness	Max 0.25 mm	Pass
Width tolerance	ASTM F2055 0.4 mm / 305 mm	Pass
Gaps between planks	Max 0.25 mm	Pass
Dimensional stability	ASTM F2199-09 (max 1.67 mm per m)	Pass
Length tolerance	ASTM F2055 0.4 mm / 305 mm	Pass
Thickness tolerance	ASTM F386 0.13 mm	Pass

Physical Properties

Test	Test method	Result
Residual indentation	ASTM F1914-07 (average max 25%)	Pass
Surface scratch resistance	ISO 1518-1: 2011 (≥ 2500 g)	≥ 2500 g
Reaction to fire classification	EN 13501-1: 2007	Bfl-s1
Airborne sound transmission (STC)	ASTM E90-09 (2016) ASTM E413-16	67
Density	ISO 1183-1: 2012 (+/-0.05 g/cm ³)	1.53-1.69 g/cm ³
Peel resistance	EN ISO 24345 - Min 50 N / 50 mm	Pass
Flexibility	ASTM F137-08 and ASTM F1700-04	Pass
Impact sound transmission (IIC)	ASTM E492-09 (2016) ASTM E989-06 (2012)	66
Slip resistance	EN 13893	Class DS
Smoke density	ASTM E662	Pass
Color stability to heat exposure	ASTM F1514-03 (max $\Delta E=8$)	Pass
Abrasion resistance	EN 660-2-1999 Range between 0.010 g-0.060 g /1000	Pass
Resistance to chemicals	ASTM F925-13 (max slight change)	Pass
Critical radiant flux class	EN ISO 24343-1	Bfl
Castor chair resistance	EN 425: 2002	Pass

Chemical Composition

Test	Test method	Result
Phthalates	Prop 65	None detected
Antibacterial wear layer	ASTM E2180-07	99.9% Reduction
TVOC (Total Volatile Organic Compounds)	CA CDPH 01350	Pass
Formaldehyde Emission	EN 717-1: 2004	Pass
Indoor air quality	SCS-EC10.3-2014 v3.0	FloorScore Certified

Pompidou 2415

Luxury Vinyl • Galleria

Styles offered



#2410 (Tile)
Accademia
Stone



#2411 (Tile)
Getty
Stone



#2412 (Tile)
Guggenheim
Stone



#2413 (Tile)
Orsay
Stone



#2414 (Tile)
Pergamon
Stone

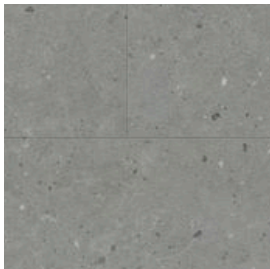

#2415 (Tile)
Pompidou
Stone

Accessories



701 Luxury Vinyl Adhesive - 4 U.S. Gallons

4 Gallons (15.14 Litres)

Porous: 1/16" x 1/16" x 1/16" V-notch Trowel

Non-Porous: 1/16" x 1/32" x 1/32" V-notch Trowel

Porous Coverage

680 - 760 sq.ft. / 4 Gallons (63 - 71 m² / 15 L)

Non-Porous Coverage

1,000 to 1,200 sq.ft. / 4 U.S. Gallons (93 to 112 m² / 15 L)

[Specifications - 701 Vinyl Flooring Adhesive](#)

[SDS - 701 Vinyl Flooring Adhesive](#)

[Label - 701 Vinyl Flooring Adhesive](#)