

# Carleton 6001

## Engineered Luxury Vinyl • Adventure

### Benefits

<b>Family friendly (including pet)</b>	100% Waterproof Easy to clean Stain resistant, including pet stains
<b>Safe and healthy</b>	Antimicrobial protective treatment to inhibit the growth of mold and mildew. Phthalates-Free products meaning that they will not affect your quality of life FloorScore® Certified for compliance with rigorous indoor air quality requirements E1 Certified meaning that the product meets the European standard for indoor air quality Made of virgin PVC (no recycled content) ensuring a uniform composition that doesn't contain any harmful substances.
<b>Performant and durable construction</b>	Commercial abrasion resistance BLC Certified ® - Ensures that the floor covering you're buying surpasses industry quality standards. Innovative construction for a long-lasting and great-looking floorcovering (WPC)
<b>Easy maintenance</b>	100% Waterproof Antimicrobial, anti-mold and anti-fungal Easy to clean Stain resistant, including pet stains
<b>Easy and versatile Installation</b>	Floating installation 2 in 1 - comes with an attached underlayment Compatible with embedded radiant heating Can be installed on all floor levels No telegraphing, even when installed over hard surface flooring Minimal floor preparation Matching moldings available
<b>Quiet and comfortable</b>	Cork backing for greater temperature and sound insulation High soundproofing ratings (IIC/STC)
<b>Notable look</b>	Matte finish
<b>Best-in-class Warranty</b>	30 Days No Questions Asked Replacement
<b>Quickship</b>	Stock product for faster delivery

# Carleton 6001

## Engineered Luxury Vinyl • Adventure

### Product Specifications

<b>Market Segments</b>	Pro, Property Management, Residential
<b>Sub Category</b>	WPC
<b>Collection</b>	Adventure
<b>Style Name</b>	Carleton
<b>Style Number</b>	6001
<b>Construction</b>	Engineered Luxury Vinyl
<b>Format</b>	Plank
<b>Abrasion Resistance</b>	General Commercial Use
<b>Material</b>	Virgin PVC
<b>Core Material</b>	70% Virgin PVC / 30% Calcium Carbonate
<b>Width</b>	7.087" (180 mm)
<b>Total Thickness</b>	0.307" (7.8 mm)
<b>Wear Layer Thickness</b>	0.0220" (0.5500 mm)
<b>Core Thickness</b>	0.1770" (4.5000 mm)
<b>Backing</b>	Cork
<b>Edges</b>	4-Sided Micro Bevel
<b>Locking System</b>	Välinge 2G: Angle-to-Angle
<b>Backing Thickness</b>	0.0590" (1.5000 mm)
<b>Finish</b>	Medium Embossed
<b>Top Surface</b>	UV-Cured Acrylic
<b>Gloss</b>	Matte
<b>Pattern Repeat</b>	5
<b>IIC</b>	72
<b>STC</b>	69
<b>Design</b>	Oak
<b>Formaldehyde</b>	E1
<b>Vinyl Thickness</b>	0.0710" (1.8000 mm)
<b>Length</b>	48.031" (1220 mm)
<b>Installation Methods</b>	Floating, Compatible with embedded radiant heating

[Engineered Luxury Vinyl Installation Guide \(Angle to Angle\)](#)  
[Engineered Luxury Vinyl Installation Video - Välinge 2G angle-to-angle Locking System](#)



### Warranties

- [Engineered Luxury Vinyl Warranty Guide](#)
- [Engineered Luxury Vinyl Maintenance Guide](#)

#### Residential use

*Fade Lifetime*  
*Wear Lifetime*  
 Manufacturing Defects  
*Lifetime*  
*Stain Resistance Lifetime*  
*Waterproof Lifetime*  
*Petproof Lifetime*  
 No Questions Asked  
 Replacement 30 days

#### Commercial use

*Petproof Lifetime*  
*Waterproof Lifetime*  
 Wear 15 Years  
 Fade 15 Years  
 Stain Resistance 15 Years  
 Manufacturing Defects 15  
 Years

# Carleton 6001

## Engineered Luxury Vinyl • Adventure

### Packaging information

<b>Units Per Box</b>	8
<b>Boxes Per Pallet</b>	65
<b>Box Weight</b>	30.63 pounds (13895.43 grams)
<b>Square Meters Per Box</b>	1.76
<b>Square Meters Per Pallet</b>	114.19
<b>Square Feet Per Box</b>	18.91
<b>Square Feet Per Pallet</b>	1229.15

### Moldings

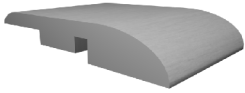

**Reducer**  
Matching  
94.488" X 0.413" X 1.771"  
(2400 mm X 10.5 mm X 45 mm)

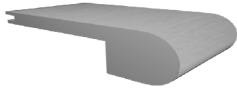

**Flushmount Stair Nose - Round**  
Matching  
94.488" X .984" X 4.330"  
(2400 mm X 25 mm X 110 mm)

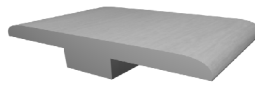

**T-Molding**  
Matching  
94.488" X 0.413" X 1.771"  
(2400 mm X 10.5 mm X 45 mm)



**Flushmount Stair Nose - Square**  
Matching  
94.488" X 1.299" X 4.449"  
(2400 mm X 33 mm X 113 mm)